

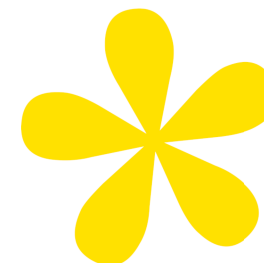







SARSA*



RIDER 2023 - PLENER

v2-2023

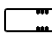
-  Robin Pointe / mode 1 (14)
-  SunBlast 3000FC / mode adv 1 (6)
-  Robin 600 LEDWash+ / mode 2 (6)
-  A.leda B-EYE K20 / mode shape (5)
-  Robin 600 LEDWash+ / mode 2 (5)
-  Ares / mode 4 channel (5)
-  Stage Blinder (4)
-  Unique 2.1 + wentylator (4)

Realizator:
Adam Kolarcik
tel. 660 413 431
akolarcik@lightvision.com.pl
Proszę o kontakt najpóźniej 10 dni przed koncertem

Manadzer:
Barbara Budniok
tel. 601 09 09 15
barbara@kayax.pl



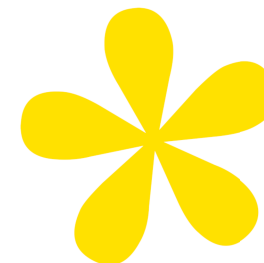



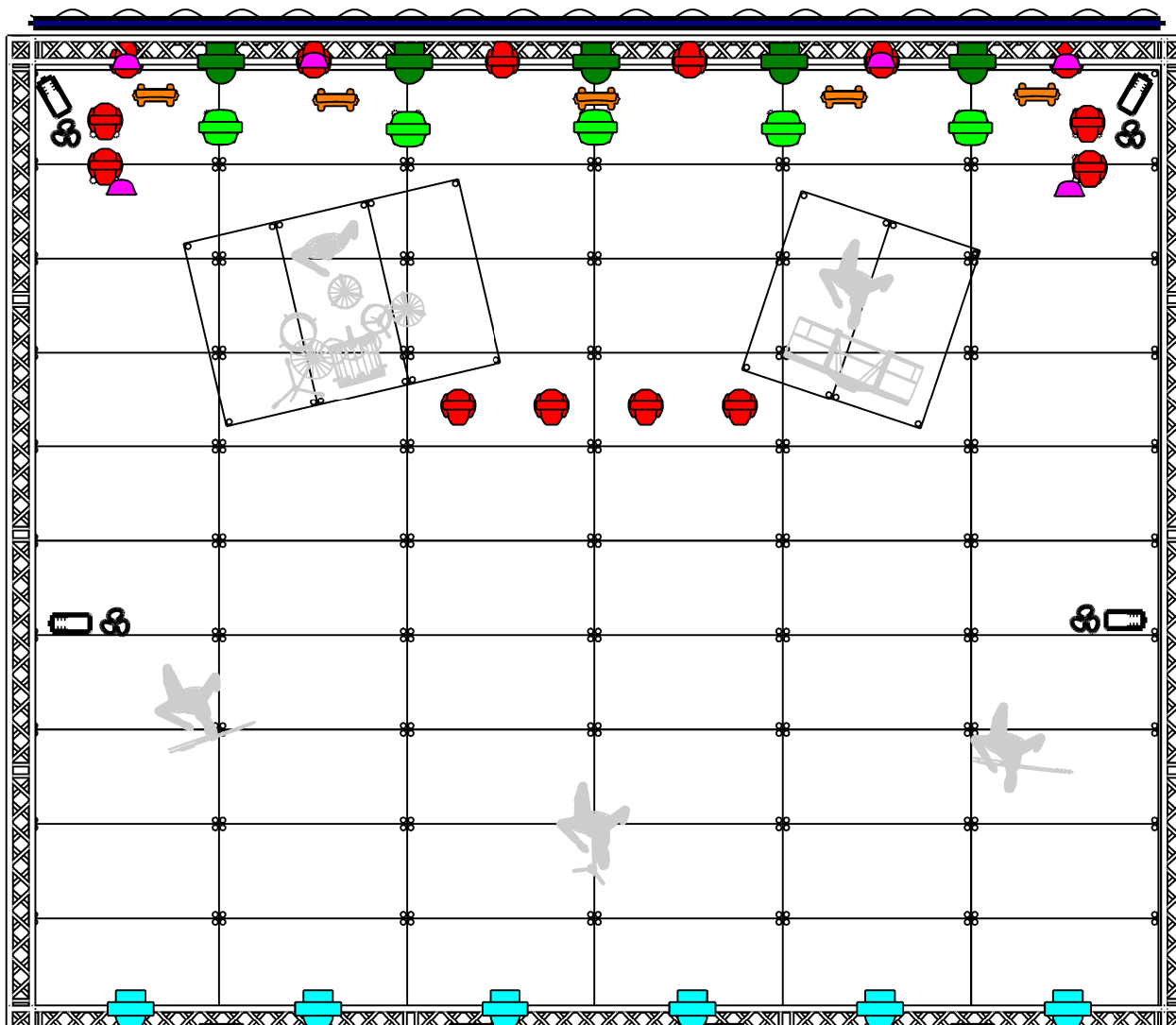

Konsoleta:
grandMA 3 light / grandMA 2 light
proszę o aktualny soft w konsolocie

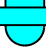

RIDER 2023 - PLENER

v2-2023



-  Robin Pointe / mode 1 (14)
-  SunBlast 3000FC / mode adv 1 (6)
-  Robin 600 LEDWash+ / mode 2 (6)
-  A.leda B-EYE K20 / mode shape (5)
-  Robin 600 LEDWash+ / mode 2 (5)
-  Ares / mode 4 channel (5)
-  Stage Blinder (4)
-  Unique 2.1 + wentylator (4)

Realizator:
Adam Kolarcik
tel. 660 413 431
akolarcik@lightvision.com.pl
Proszę o kontakt najpóźniej 10 dni przed koncertem

Manadzer:
Barbara Budniok
tel. 601 09 09 15
barbara@kayax.pl



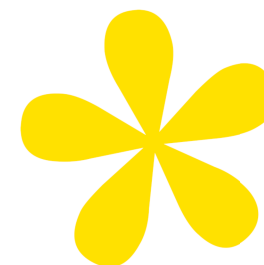



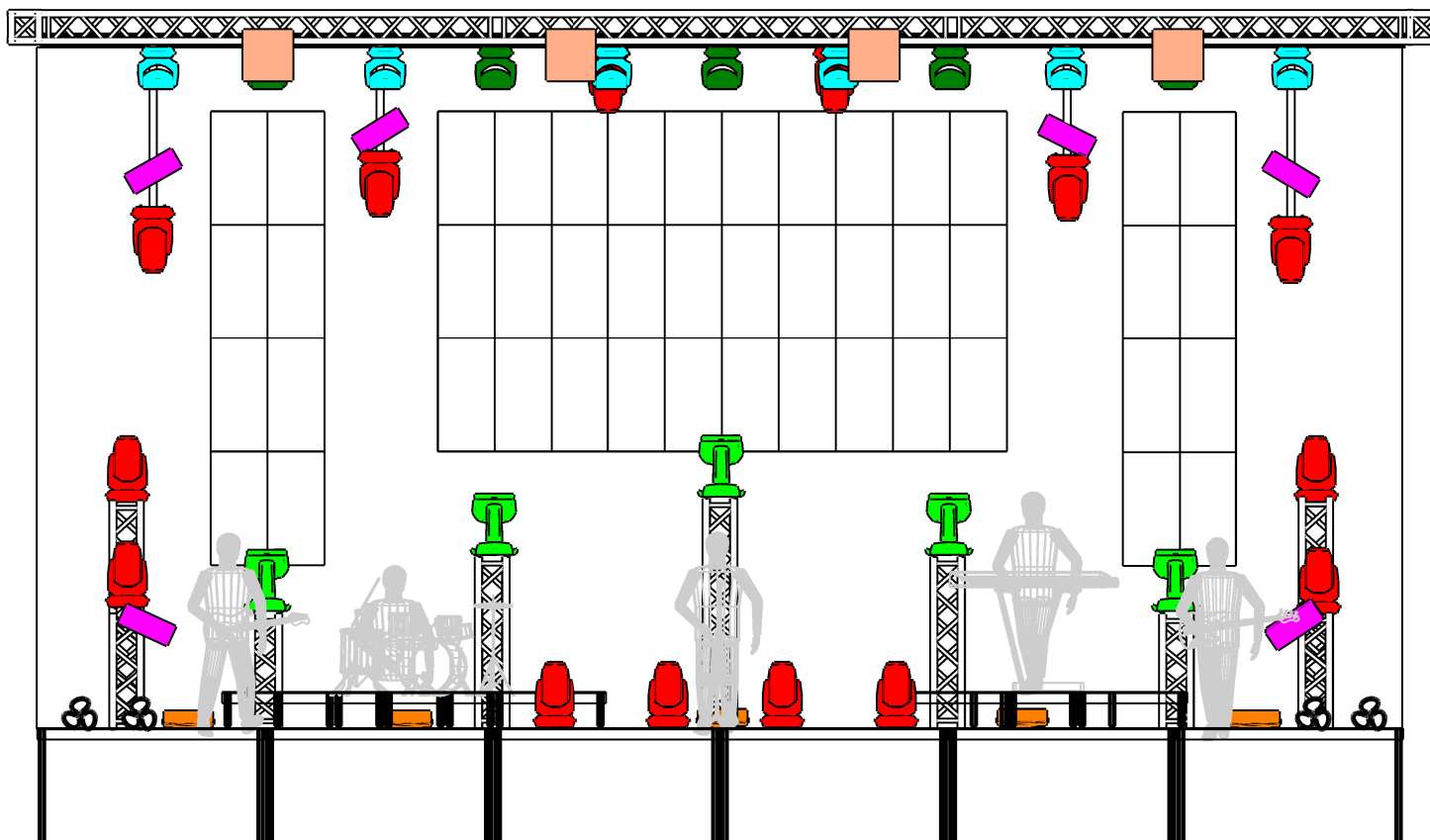

Konsoleta:
grandMA 3 light / grandMA 2 light
proszę o aktualny soft w konsolocie

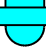

RIDER 2023 - PLENER

v2-2023



-  Robin Pointe / mode 1 (14)
-  SunBlast 3000FC / mode adv 1 (6)
-  Robin 600 LEDWash+ / mode 2 (6)
-  A.leda B-EYE K20 / mode shape (5)
-  Robin 600 LEDWash+ / mode 2 (5)
-  Ares / mode 4 channel (5)
-  Stage Blinder (4)
-  Unique 2.1 + wentylator (4)

Realizator:
Adam Kolarcik
tel. 660 413 431
akolarcik@lightvision.com.pl
Proszę o kontakt najpóźniej 10 dni przed koncertem

Manadzer:
Barbara Budniok
tel. 601 09 09 15
barbara@kayax.pl

Konsoleta:
grandMA 3 light / grandMA 2 light
proszę o aktualny soft w konsolocie

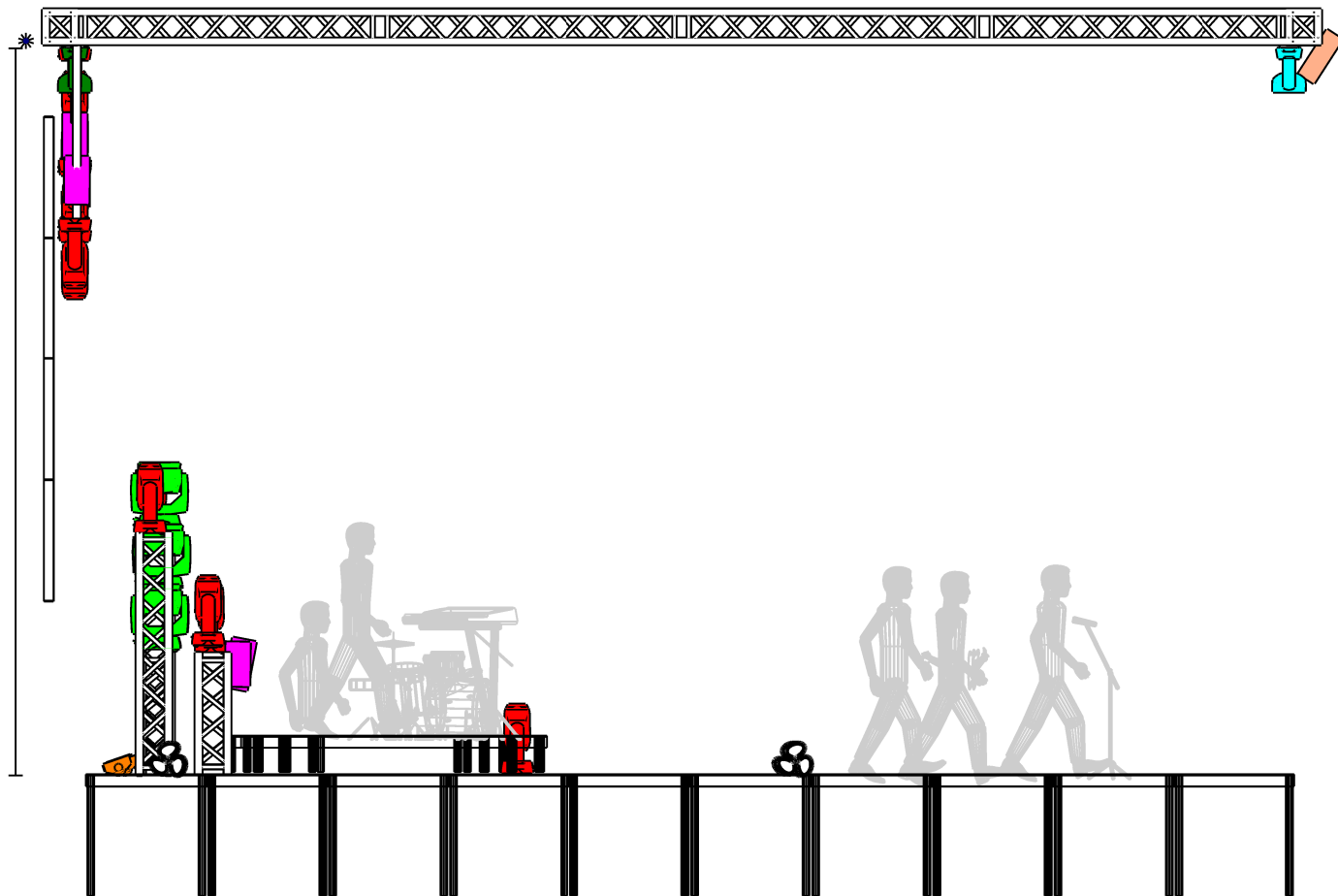



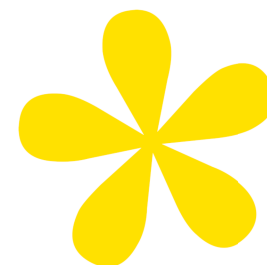



SARSA*



RIDER 2023 - PLENER

v2-2023

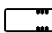
-  Robin Pointe / mode 1 (14)
-  SunBlast 3000FC / mode adv 1 (6)
-  Robin 600 LEDWash+ / mode 2 (6)
-  A.leda B-EYE K20 / mode shape (5)
-  Robin 600 LEDWash+ / mode 2 (5)
-  Ares / mode 4 channel (5)
-  Stage Blinder (4)
-  Unique 2.1 + wentylator (4)

Realizator:
Adam Kolarcik
tel. 660 413 431
akolarcik@lightvision.com.pl
Proszę o kontakt najpóźniej 10 dni przed koncertem

Manadzer:
Barbara Budniok
tel. 601 09 09 15
barbara@kayax.pl



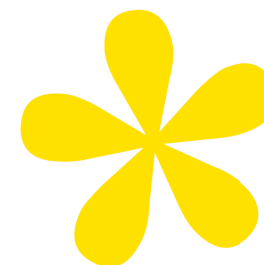



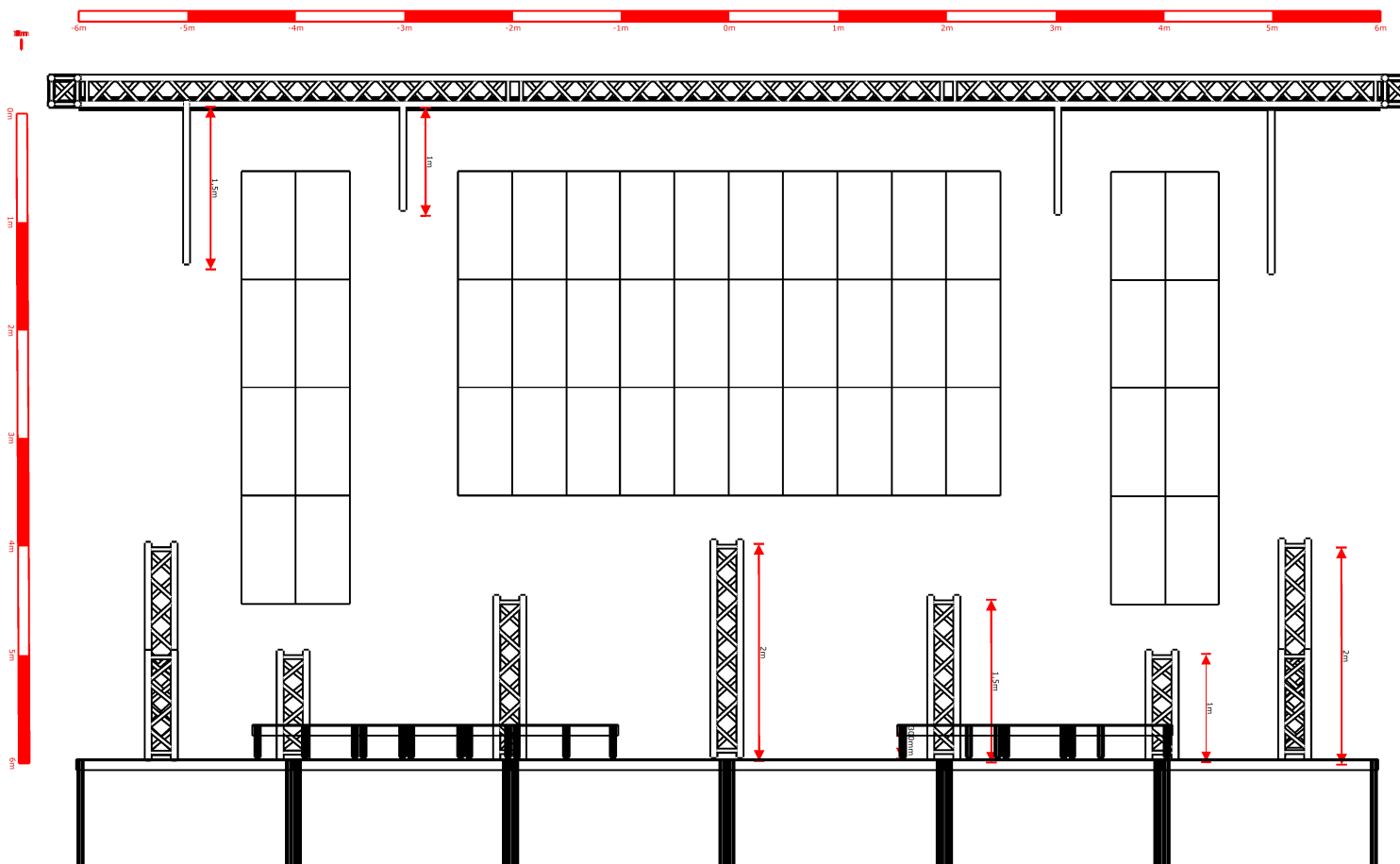

Konsoleta:
grandMA 3 light / grandMA 2 light
proszę o aktualny soft w konsolocie



RIDER 2023 - PLENER

v2-2023



-  Robin Pointe / mode 1 (14)
-  SunBlast 3000FC / mode adv 1 (6)
-  Robin 600 LEDWash+ / mode 2 (6)
-  A.leda B-EYE K20 / mode shape (5)
-  Robin 600 LEDWash+ / mode 2 (5)
-  Ares / mode 4 channel (5)
-  Stage Blinder (4)
-  Unique 2.1 + wentylator (4)

Realizator:
Adam Kolarcik
tel. 660 413 431
akolarcik@lightvision.com.pl
Proszę o kontakt najpóźniej 10 dni przed koncertem

Manadzer:
Barbara Budniok
tel. 601 09 09 15
barbara@kayax.pl

Konsoleta:
grandMA 3 light / grandMA 2 light
proszę o aktualny soft w konsolocie

MULTIMEDIA

Ekran led - 23 m2
Maksymalny pixel P6
Przewód HDMI doprowadzony do stanowiska realizatora światła

Urządzenia należy zainstalować zgodnie z projektami załączonymi powyżej.

Wszystkie urządzenia powinny być w 100% sprawne.

W miarę możliwości proszę aby konstrukcje oświetleniowe, kraty, rury, zawiesia były w kolorze czarnym.

Powyższa lista sprzętu jest aktualna dla sceny nie większej niż 12m x 10m w przypadku większych scen wymagania mogą ulec zmianie.

W oknie sceny nie mogą znajdować się reklamy, bannery itp.

Latarnie i inne źródła światła w sąsiedztwie sceny muszą na czas koncertu zostać wyłączone.

Niezbędne jest wysłonięcie sceny z trzech stron nieprześwitującym czarnym materiałem.

Konsoleta musi znaleźć się w osi sceny, mile widziane podwyższenie.

Stanowisko monitorowe nie powinno znajdować się bezpośrednio w oknie sceny.

Wszystkie ewentualne zmiany muszą być uzgadniane z realizatorem oświetlenia.

Realizator:

Adam Kolarcik

tel. 660 413 431

akolarcik@lightvision.com.pl

Proszę o kontakt najpóźniej 10 dni przed koncertem

Manadzer:

Barbara Budniok

tel. 601 09 09 15

barbara@kayax.pl

SARSA*

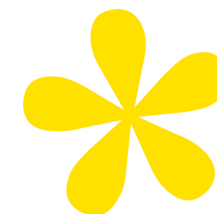

RIDER 2023 - PLENER

v2-2023



Robin Pointe / mode 1 (14)



SunBlast 3000FC / mode adv 1 (6)



Robin 600 LEDWash+ / mode 2 (6)



A.leda B-EYE K20 / mode shape (5)



Robin 600 LEDWash+ / mode 2 (5)



Ares / mode 4 channel (5)



Stage Blinder (4)









Unique 2.1 + wentylator (4)

Konsoleta:

grandMA 3 light / grandMA 2 light

proszę o aktualny soft w konssolecie

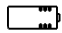
ZAMIENNIKI URZĄDZEŃ

-  Robin Pointe - mega Pointe
-  Robin 600 LEDWash+ - Robin 600 / 800
-  SunBlast 3000FC - Brighter pixel strobe / atomic 3000
-  A.leda B-EYE K20 / K25
-  Robin 600 LEDWash+ - Robin 600 / 800 / b-eye K20 / K15 / K20 / K25
-  Unique 2.1 + wentylator - dowolny markowy hazzer z dedykowanym płynem
-  Ares - dowolny naświetlacz RGBW z frostem około 45*

W przypadku zamienników proszę aby na miejscu były w pełni działające biblioteki dla urządzeń.

Konsoleta:

grandMA 2 full size / light
grandMA 3 full size / light

Nie akceptujemy konsolet ultra light oraz urządzeń typu wing.

Follow Spot

W przypadku sceny z wybiegiem proszę zapewnić follow spot o mocy odpowiedniej dla odległości sceny wraz z operatorem. Jeśli stanowisko operatora znajduje się poza możliwością bezpośredniego kontaktu z realizatorem światła, prosimy o zapewnienie łączności intercom. Jeśli scena nie ma wybiegu,

Realizator:

Adam Kolarcik
tel. 660 413 431

akolarcik@lightvision.com.pl

Proszę o kontakt najpóźniej 10 dni przed koncertem

Manadzer:

Barbara Budniok
tel. 601 09 09 15





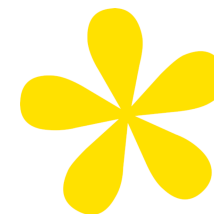



barbara@kayax.pl

SARSA*



RIDER 2023 - PLENER

v2-2023

-  Robin Pointe / mode 1 (14)
-  SunBlast 3000FC / mode adv 1 (6)
-  Robin 600 LEDWash+ / mode 2 (6)
-  A.leda B-EYE K20 / mode shape (5)
-  Robin 600 LEDWash+ / mode 2 (5)
-  Ares / mode 4 channel (5)
-  Stage Blinder (4)
-  Unique 2.1 + wentylator (4)

Konsoleta:

grandMA 3 light / grandMA 2 light
proszę o aktualny soft w konsolecie